

## HARROWES MEADE

EDGWARE, HA8 8RS

**£850,000**  
**FREEHOLD**

Taylor Hawkins is excited to present this lovely three-bedroom semi-detached house on Harrowes Meade, Edgware. Ideally located close to schools, shops, and public transport, this home offers both convenience and comfort.

Inside, you'll find a bright and welcoming space filled with natural light. The house includes a handy downstairs toilet and a utility room, while the generously sized garden provides plenty of room to enjoy the outdoors.

Upstairs, the bedrooms are spacious, with built-in wardrobes and plenty of storage. The property also has great potential for a rear extension, garage conversion, or loft conversion (subject to planning permission), giving you the chance to add your personal touch.



**TAYLOR HAWKINS**  
Estate Agents  
0208 958 2222 / [TaylorHawkins.co.uk](http://TaylorHawkins.co.uk)



**Harrowes Meade, Edgware, HA8**

Approximate Area = 1322 sq ft / 122.8 sq m  
 Garage = 131 sq ft / 12.1 sq m  
 Total = 1453 sq ft / 134.9 sq m  
 For identification only - Not to scale

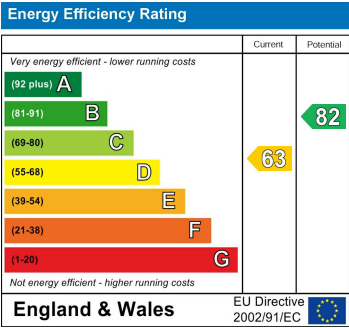
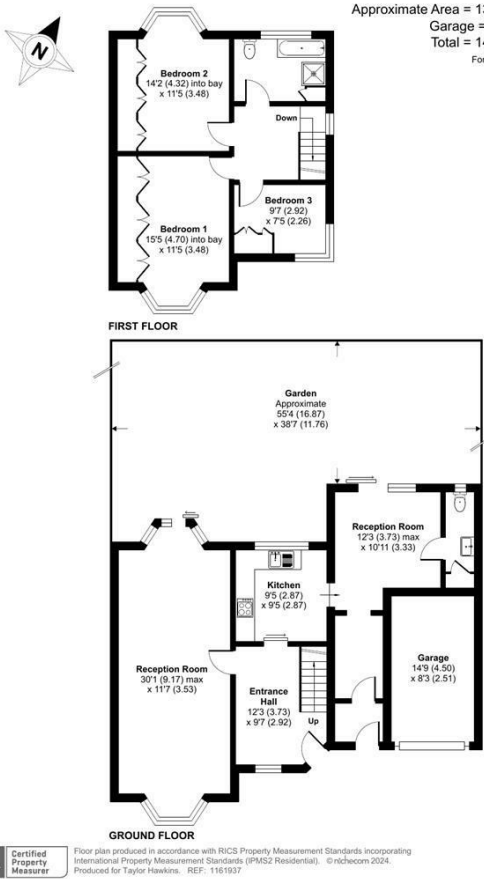

Agents Note: Whilst every care has been taken to prepare these particulars, they are for guidance purposes only. All measurements are approximate and are for general guidance purposes only and whilst every care has been taken to ensure their accuracy, they should not be relied upon and potential buyers/tenants are advised to recheck the measurements

Edgware Sales  
 58 Edgware Way  
 Edgware  
 Middlesex  
 HA8 8DJ

020 8958 2222  
[property@taylorhawkins.co.uk](mailto:property@taylorhawkins.co.uk)  
<https://taylorhawkins.co.uk/>

